

CP- EAC-FY60M-E
Metal UFO Dome Camera

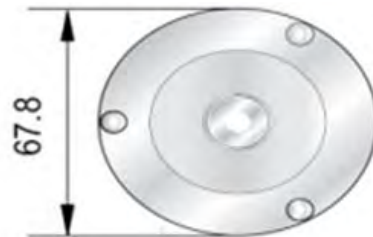

Main Features

- 1/3" Sony CCD
- High Resolution of 600 TVL
- Low light performance at 0.01Lux
- 2.8MM
- Support Digital- WDR and 2DNR
- OSD



**CP- EAC-FY60M-E**
Metal UFO Dome Camera**Feature**

Image Sensor
Pixels
Resolution
Min. Illumination
S/N Ratio
Electronic Shutter
Iris Control
Lens
White Balance (AWB)
Gain Control (AGC)
Back Light Compensation
WDR
Sync
Video Output
Special Functions
Power Supply
Weight
Operating Temperature
Certifications

Specification

1/3" Sony CCD
PAL:752(H)x582(V); NTSC: 768(H)x494(V)
600 TVL(2040+639BK)
0.01 Lux
More than 50dBAGC OFFj
PAL:1/50`1/100000s; NTSC:1/60`1/100000s
Fixed Iris
3.7mm Pinhole Lens
Auto
Auto
Auto BLC
D-WDR
Internal Synchronization
1.0Vp-p,75 Û, BNC
OSD, 2DNR
DC12V
310
-10 ~ + 50 °C
CE, FCC & ROHS



1141 Budapest, Fogarasi út 77. 1095 Budapest, Mester u. 34.
Tel.: *220-7940, 220-7814, 220-7959, Tel.: *218-5542, 215-9771, 215-7550,
220-8881, 364-3428 Fax: 220-7940 216-7017, 216-7018 Fax: 218-5542
Mobil: 30 531-5454, 30 939-9989 Mobil: 30 940-1970, 20 949-2688

www.cplusplus.hu

E-mail: info@delton.hu Web: www.delton.hu

